



A NAVISTAR COMPANY

DYK – SMU – 007

## Did You Know...?

SALES & MARKETING UPDATE

# Corrosion Protection Available with International<sup>®</sup> TerraStar<sup>®</sup>, DuraStar<sup>®</sup> and WorkStar<sup>®</sup> Trucks

Maximize corrosion protection on your next International<sup>®</sup> truck! A broad range of new features are now available that can make a big difference when it comes to fighting the effects of corrosion on TerraStar<sup>®</sup>, DuraStar<sup>®</sup> and WorkStar<sup>®</sup> model trucks. Be sure to check Sales Tools for availability on your specific truck model.

- **E-Coated Frame Rails**

This special E-coating provides superior corrosion fighting protection for frame rails (single or reinforced), even in the harshest environments. This feature is currently available on all WorkStar models and currently requires an SQ.

- 10021 Chassis Coating – Corrosion Resistant Primer Coating for Single Frame Rails
- 10022 Chassis Coating – Corrosion Resistant Primer Coating for Reinforced Frame Rails

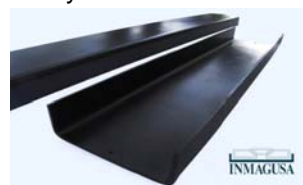

- **Tectyl chassis coating provides maximum corrosion protection for frames, cross-members, tanks and other chassis mounted equipment.**

TECTYL 2102 is a solvent reduced rubberized coating formulated to dry quickly, retain flexibility and provide a textured appearance. The film is black and extremely flexible. Can be top coated if required with automotive type finishes.

**These special coatings are now available at our International Truck Specialty Centers (TSC). Please call for pricing information (800) 641-4000.**



**Mega  
Brackets**



**Tanks**



**Frame Rails &  
Cross Members**

- **Huck Spin II Bolt and Collars (a standard feature on all International models)**

- Each Huck Spin II bolt is thoroughly cleaned then coated with Geomet<sup>®</sup> 321, a non-electrolytic ally applied thin-film coating of metallic grey color for corrosion protection.
- Each bolt collar is zinc electroplated with a black-dyed trivalent chromate. The collars are then lubed with cetyl alcohol flake.
- **Bolts installed prior to chassis paint** receive a zinc phosphate coating.
- **Bolts installed after chassis paint** are coated with a zinc phosphate protective coating then covered by a zinc-rich basecoat, and then an integrally lubricated aluminum-rich topcoat.



- **Swept back stainless steel clad aluminum bumper (01LZD)**

- Available on all WorkStar models.



- **Brake system improvements – Vehicles equipped with traction control or stability control systems now include a newly designed ATR-6 valve.**

- This has virtually eliminated corrosion issues with internal brake valve componentry.



- **Polished Aluminum Air Tank with straight thread O-ring ports (04VGM)**

- **Painted Aluminum Air Tank with straight thread O-ring ports (04VGN)**

- **Aluminum Battery box options**

- **08VTJ** - BATTERY BOX Aluminum, with Aluminum Cover, 25" Wide, 2, 3 Battery Capacity, Mounted Left Side Under Cab
- **08VTK** - BATTERY BOX Aluminum, with Plastic Cover; Mounted 26" Back of Cab, Left Side Perpendicular to Frame Rail
- **08VTL** - BATTERY BOX Aluminum, with Plastic Cover; 18" Long By 30" Wide, for 2, 3, or 4 Battery Capacity, Mounted Left Side Behind Fuel Tank
- **08VTM** - BATTERY BOX Aluminum, with Plastic Cover, 18" Long By 30" Wide, for 2, 3, or 4 Battery Capacity, Mounted Right Side Behind Fuel Tank
- **08VTN** - BATTERY BOX Aluminum, with Plastic Cover; Mounted 35" Back of Cab, Right Side Perpendicular to Frame Rail
- **08VTP** - BATTERY BOX Aluminum, with Plastic Cover; Mounted 72" Back of Cab, Left Side Perpendicular to Frame Rail
- **08VTR** - BATTERY BOX Aluminum, with Plastic Cover; Mounted 35" Back of Cab, Left Side Perpendicular to Frame Rail

- **Battery Box cover options**

- **08WWD** - BATTERY BOX COVER Stainless Steel, Bright Finish
- **08598** - BATTERY BOX COVER Anodized Aluminum

- **Sealed Battery Terminals (08875)**

- The contact surfaces of the sealed battery terminals are encased to shield against the effects of the operating environment and to reduce corrosion

- **Battery System {Deka 9A31} Maintenance-Free (3) AGM 12-Volt 2775CCA Total (08MMG)**

Absorbed Glass Mat Batteries are a newer type of sealed battery that can take much more abuse. Since all the electrolyte (acid) is contained in the glass mats, they cannot spill, even if broken and are practically immune to freeze damage.



- **Remote Power Modules now have a special anodized coating for improved corrosion protection, especially for modules mounted outside of cab.**

- For added protection, RPM's can be mounted inside the cab (behind the drivers' seat).



- **Aluminum fuel tanks are standard equipment on all models except the TerraStar® truck**

- **Stainless Steel Fuel Tank Straps**

- 15924 – Bright finish stainless steel fuel tank straps
- 15960 – Bright finish stainless steel fuel tank straps for dual fuel Tanks



- **Aluminum Steps**
  - 16XTK – Two bright finish aluminum steps per door
  - 16WTM – Two non-bright finish aluminum steps per door
  - 16ZBB – Two aluminum self-cleaning steps (Bustin) per door
- **Double sided galvanized steel cab receives a multi-staged pretreatment system consisting of zinc phosphate followed by cathodic e-coat.**

Then.....

- **5-Step Corrosion Protection & Clear Coat Paint Process (Standard)**
  - High concentration color coating:
    - The cab is sprayed with a high concentration colored paint that is meticulously applied to the cab by a robotic paint system.
  - Clear coat urethane sealant: Finally, the corrosion protection system applies a clear Urethane coating for a final corrosion protection barrier.
  - 60-month/unlimited-mileage cab/cowl perforation corrosion coverage

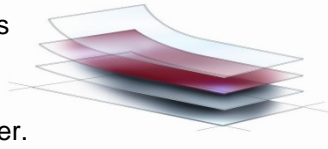

- **Transmission control module (Allison) relocated inside cab (13WYH)**

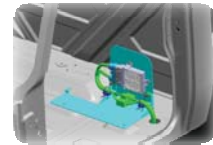

- **Metal – Plastic – Metal Composite Oil Pan with Block Heater for use with MaxxForce® DT/9/10 engines (12WTH)**

- The unique 3 layer design prolongs the expected useful life of the oil pan
- E-coat/powder coat outer surface provides excellent corrosion protection
- The plastic (middle layer) absorbs and dissipates the energy of road debris as it comes into contact with the metal outer layer. This prolongs the service life of the outer pan layer.

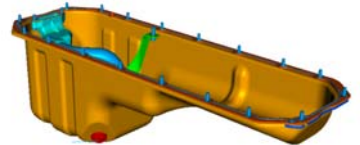

- **An aluminum oil pan is a standard feature on the MaxxForce® 7 engine.**

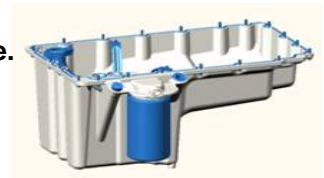

All trademarks are marks of their respective owners.